

## PHASE 1 WATER SYSTEM IMPROVEMENT PLANS

FOR

# ALMANOR HEIGHTS MUTUAL WATER COMPANY

LOCATED IN

## PRATTVILLE, PLUMAS COUNTY, CALIFORNIA

### GENERAL

PRIOR TO CONSTRUCTION, ANY PERMITS SHALL BE OBTAINED FROM PLUMAS COUNTY ROAD DEPARTMENT.

DISINFECTION: USE MINIMUM OF 2 CHLORINE TABLETS PER 20' LENGTH. CLUE WITH PERMEX 200-11 SEALANT. USE CHLORINE SLABS WHERE NEEDED. PERMEX 200-11 SEALANT IS AVAILABLE FROM PLUMAS COUNTY WATER DEPARTMENT, 4000 W. 1ST ST., PRATTVILLE, CA 95662. IN CONSULTANCE WITH DWS, AMWA, ASPL, NSF, AND TITLE 22 STANDARDS.

ALL WORK REQUIRING REPERCUSSION OF DOMESTIC WATER SERVICE MUST BE SCHEDULED WITH AND DONE UNDER THE DIRECT SUPERVISION OF THE AWWAC WHO WILL DICATE APPROPRIATE CONSTRUCTION AND DISINFECTION TIMES.

CONTRACTOR SHALL PROVIDE AND INSTALL CLASS 150 C-300 PVC PIPING AS SHOWN ON THE PLANS. INSTALLATION, TESTING, AND DISINFECTION SHALL BE COMPLETED ON LINE AT THE 3M EDGE BLUE BROTE INSTALLATION. GETTABLE ON LINE AT <http://www.finepipe.com/plastic-pipe/downloads/installation-update.html>

### SITE SAFETY

NE ENGINEERING, INC.'S SITE RESPONSIBILITIES ARE LIMITED SOLELY TO THE ACTIVITIES OF NST AND NST'S EMPLOYEES ON SITE. THESE RESPONSIBILITIES SHALL NOT BE INFERRED BY ANY PARTY TO MEAN THAT NST HAS RESPONSIBILITY FOR SITE SAFETY, SAFETY IN, ON, OR ABOUT THE SITE IS THE SOLE RESPONSIBILITY OF THE CONTRACTOR. THE CONTRACTOR SHALL BE RESPONSIBLE FOR THE CONTRACTOR'S METHODS OF WORK PERFORMANCE, SUPERVISION OF THE CONTRACTOR'S EMPLOYEES, AND SCHEDULING OF CONSTRUCTION ARE ALSO THE SOLE AND EXCLUSIVE RESPONSIBILITIES OF THE CONTRACTOR ALONE.

### SITE PREPARATION

#### GENERAL

ERECT AND MAINTAIN TEMPORARY LIGHTS, BARRICADES, AND CONSTRUCTION SIGNS TO PROTECT THE PROJECT FROM DAMAGE TO ADJACENT PRIVATE PROPERTY FROM DAMAGE. ALL IN ACCORDANCE WITH APPLICABLE CODES AND REGULATIONS. ALL UTILITY LOCATIONS SHALL BE DETERMINED BEFORE EXCAVATION. ALL EXCAVATION SHALL BE COMPLETED WITHIN 10 BUSINESS DAYS AFTER RECEIVING ADOPTING LAND OWNER IS OBTAINED.

### WATER LINE

#### TRENCHING

KEEP TRENCHES AND EXCAVATED AREAS FREE FROM EXCESS WATER. EXCESS WATER SHALL BE DIVERTED TO A DRAINAGE SYSTEM OR TO AN EXCAVATED AREA FROM DAMAGE BY WEATHER OR CONSTRUCTION WORK. TRENCH BEDDING AND BACKFILL SHALL FOLLOW THE RECOMMENDATIONS AS OBTAINED FROM.

WHEN EXCAVATION WORK ENCOUNTERS SOID ROCK OR OTHER UNDESIRABLE MATERIAL, SUCH MATERIAL SHALL BE REMOVED TO 6 INCHES BELOW THE NORMAL TRENCH DEPTH AND REPLACED WITH SUITABLE MATERIAL.

WHEN A FIRM FOUNDATION IS NOT ENCOUNTERED DUE TO SOFT, SPRING OR OTHER UNSUITABLE MATERIAL, SUCH MATERIAL SHALL BE REMOVED TO 6 INCHES BELOW THE NORMAL TRENCH DEPTH AND REPLACED WITH SUITABLE MATERIAL.

#### BACK FILL

BEDDING AND INITIAL BACK FILL SHALL BE NON-PLASTIC SAND AND AGGREGATE WITH 100% PASSING 3/8" SIEVE AND NO MORE THAN 7% PASSING #200 SIEVE (INDICATED AS SAND BEDDING ON PLANS).

SELECT FILL (AS SHOWN ON THESE PLANS) SHALL CONSIST OF ALL SITE EXCAVATIONS WITH ROCK SIZES LARGER THAN 3" BEING REMOVED. THIS SELECT FILL SHALL ONLY BE USED IN NON-STRUCTURAL AREAS (NOT IN THE ROAD BED).

SUBBER GRADENT BACK FILL SHALL BE USED WITHIN THE ROADWAY AND SHALL CONFORM TO THE REQUIREMENTS OF SECTION 19-1.062, CAL. TRANS STANDARDS SPECIFICATIONS.

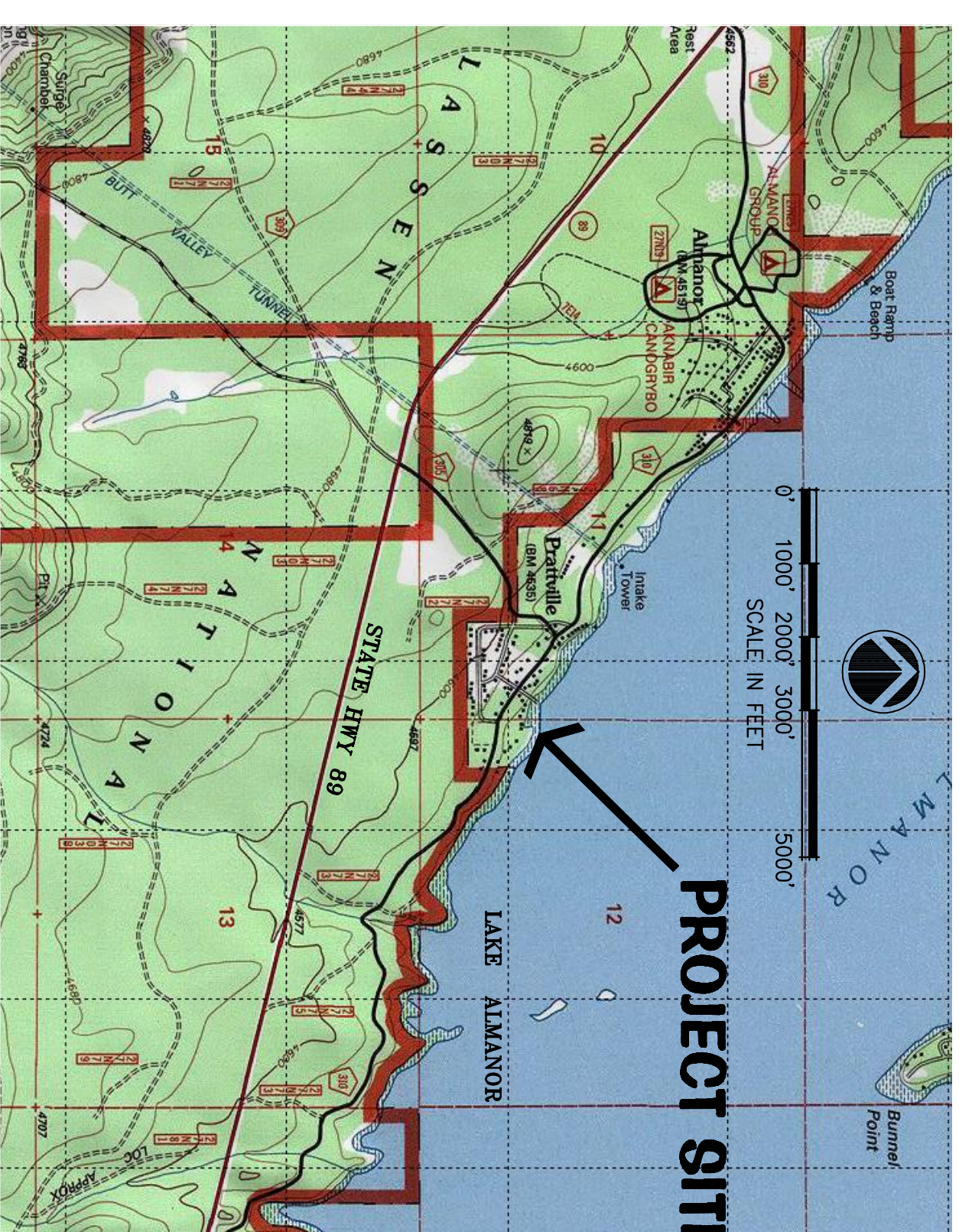

VICINITY MAP

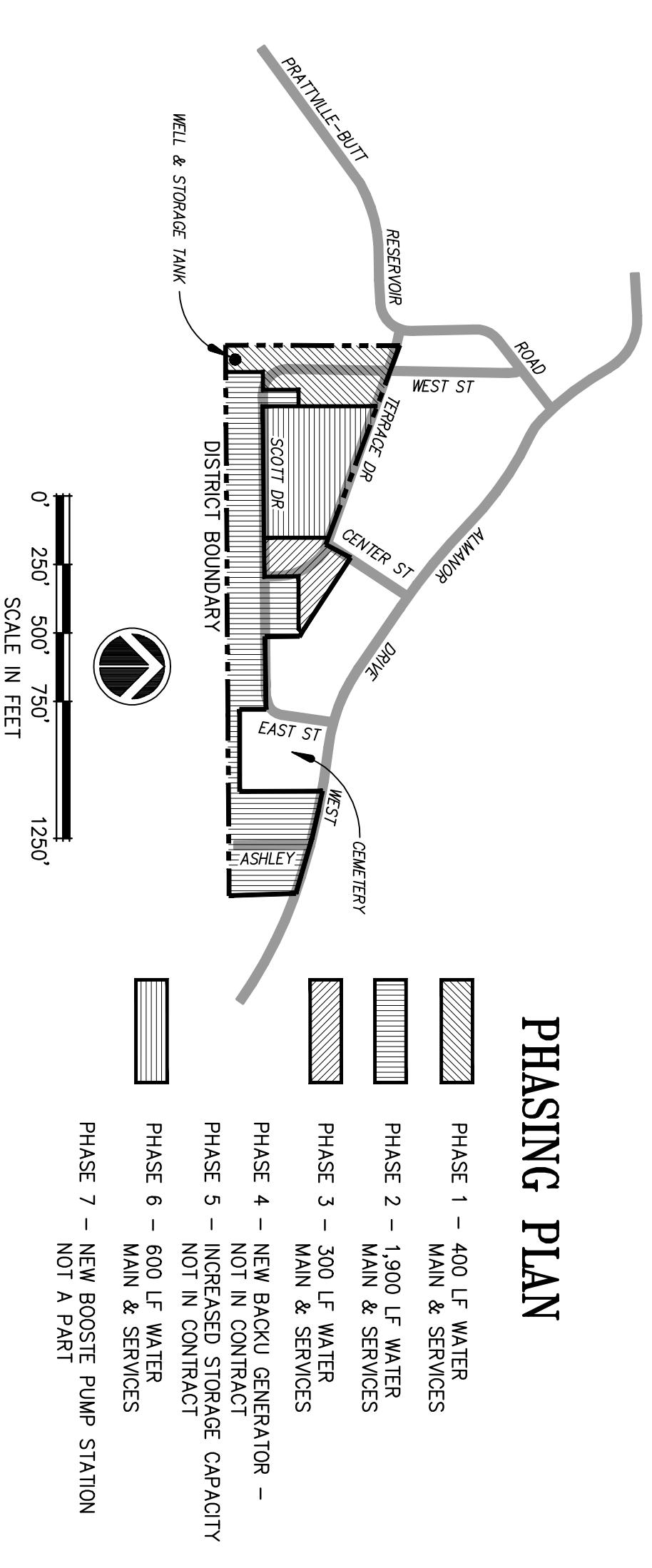

PHASING PLAN

- PHASE 1 - 400 LF WATER MAIN & SERVICES
- PHASE 2 - 1,900 LF WATER MAIN & SERVICES
- PHASE 3 - 300 LF WATER MAIN & SERVICES
- PHASE 4 - NEW BACKUP GENERATOR - NOT IN CONTRACT
- PHASE 5 - INCREASED STORAGE CAPACITY NOT IN CONTRACT
- PHASE 6 - 600 LF WATER MAIN & SERVICES
- PHASE 7 - NEW BOOSTER PUMP STATION NOT A PART

### OWNER / CONTACT

ALMANOR HEIGHTS MUTUAL WATER COMPANY  
 PRATTVILLE, CALIFORNIA  
 P.O. BOX 934  
 CHESTER, CA 96020  
 CONTACT: JOHN POURCROY, PRESIDENT  
 (530) 864-9372

### SHEET INDEX

PHASE	SHEET No.	TITLE, VICINITY & PHASING
PHASE 1	SHEET No. C1	TITLE, VICINITY & PHASING
FUTURE	SHEET No. C2	PHASE 1 PLAN & PROFILE
FUTURE	SHEET No. C3	PHASE 2 PLAN & PROFILE
FUTURE	SHEET No. C4	PHASE 3 PLAN & PROFILE
FUTURE	SHEET No. C5	PHASE 3 PLAN & PROFILE
FUTURE	SHEET No. C6	PHASE 6 PLAN & PROFILE
PHASE 1	SHEET No. C7	PHASE 1 DETAILS
PHASE 1	SHEET No. C8	PHASE 1 DETAILS

### APPROVALS

DESIGNED BY: JEFFERY MORRISH, RCE 369929  
 NST ENGINEERING, INC.

APPROVED FOR CONSTRUCTION: JOHN POURCROY, PRESIDENT  
 ALMANOR HEIGHTS MUTUAL WATER COMPANY, INC.

NO.	DATE	DESCRIPTION	BY
REVISIONS			

NST Engineering, Inc.  
 1485 Riverside Drive  
 Suite 100  
 Prattville, CA 95662  
 (530) 867-5173

DRAWN BY: KMB  
 CHECKED BY: JAM  
 DATE: 9/19/11  
 JOB No. 2011-041

## TITLE, VICINITY & PHASING